



● Thank you for purchasing the our product. Before installing, please read the instruction carefully and keep it for future re ference.

⚠ NOTICE

- To install, follow the steps as described in the manual. Any damages caused by not following directions voids warranty.
- Correct tools must be used for installation.
- Do not modify any parts unless specifically stated in the instruction manual.
- Interior controller maintenance should be performed by a professional only.

◎ **SYMBOL NOTE:**

NOTE Read this information carefully regarding the essential features.

⚠ Some procedures must be followed to avoid damages to the instrument.

⚠ **CAUTION!** Some processes must be followed to avoid the damage to the vehicle.

🔧 To smear grease before installation.

🔩 Denotes the tightening torque value.

1 ACCESSORY

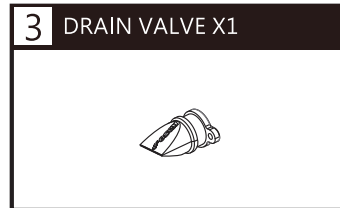

NOTE Please contact your local distributor if the items received are not the same as the one listed above.

2 INSTALLATION INSTRUCTION

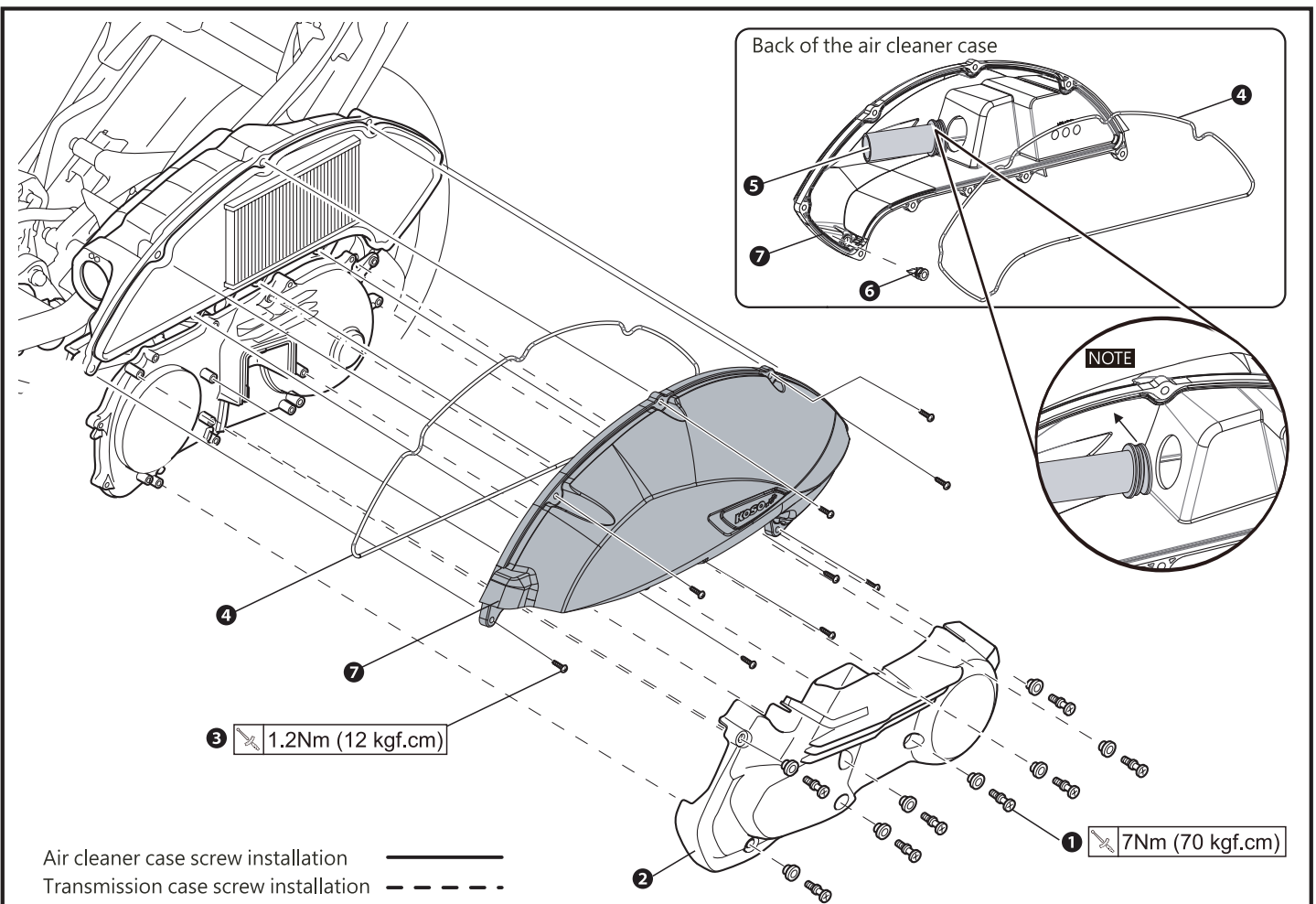

PLEASE PROCEED AS FOLLOWS

1. Please use appropriate tools to remove the ① original screw of the transmission case X8 and the ② original transmission case.
2. Please use appropriate tools to remove the ③ original screws of the air cleaner case X9 and the original air cleaner case.
3. Install the ④ sealing ring (Accessory 2), the ⑤ original tube, and the ⑥ drain valve (Accessory 3) on the ⑦ KOSO air cleaner case (Accessory 1).
4. Please use appropriate tools to install the ⑧ KOSO air cleaner case (Accessory 1) on the air cleaner case body.

NOTE It is recommended to install the flange mark toward the arrow's direction.

3 CURVE TEST DIAGRAM

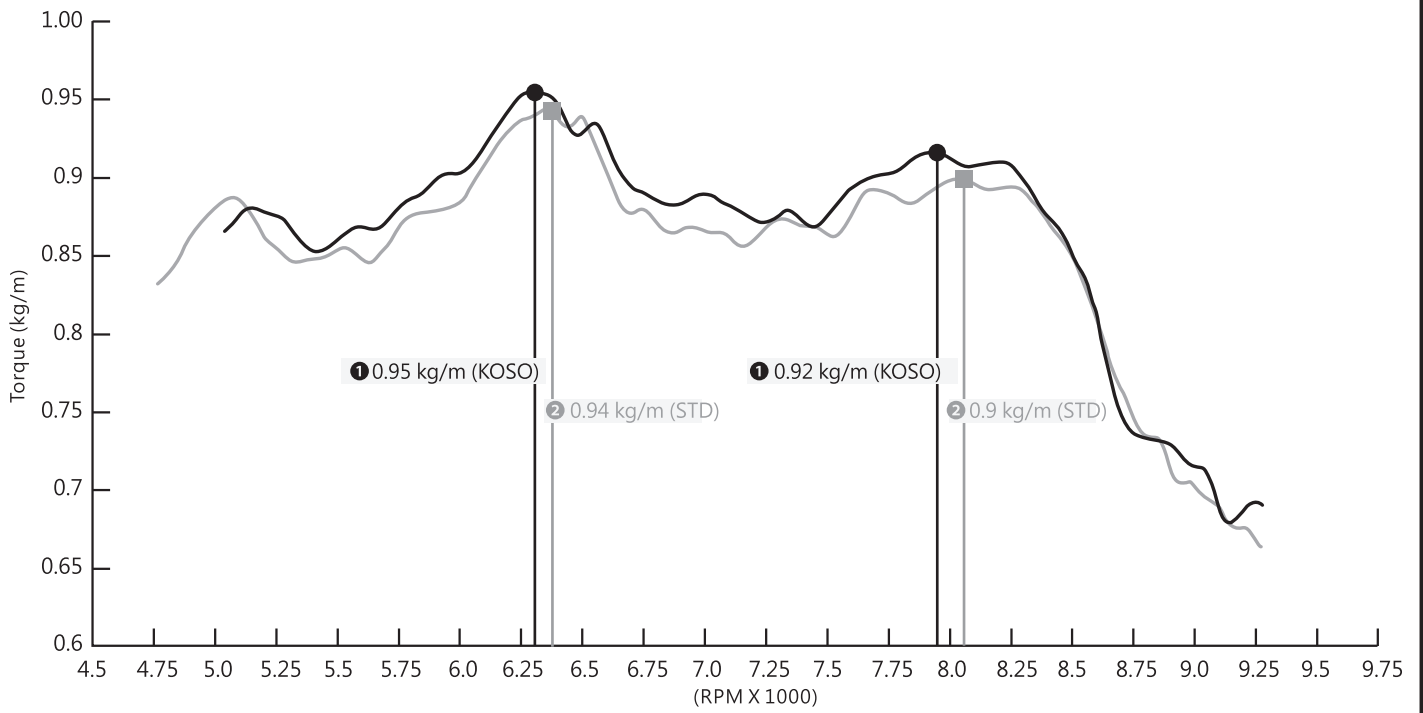
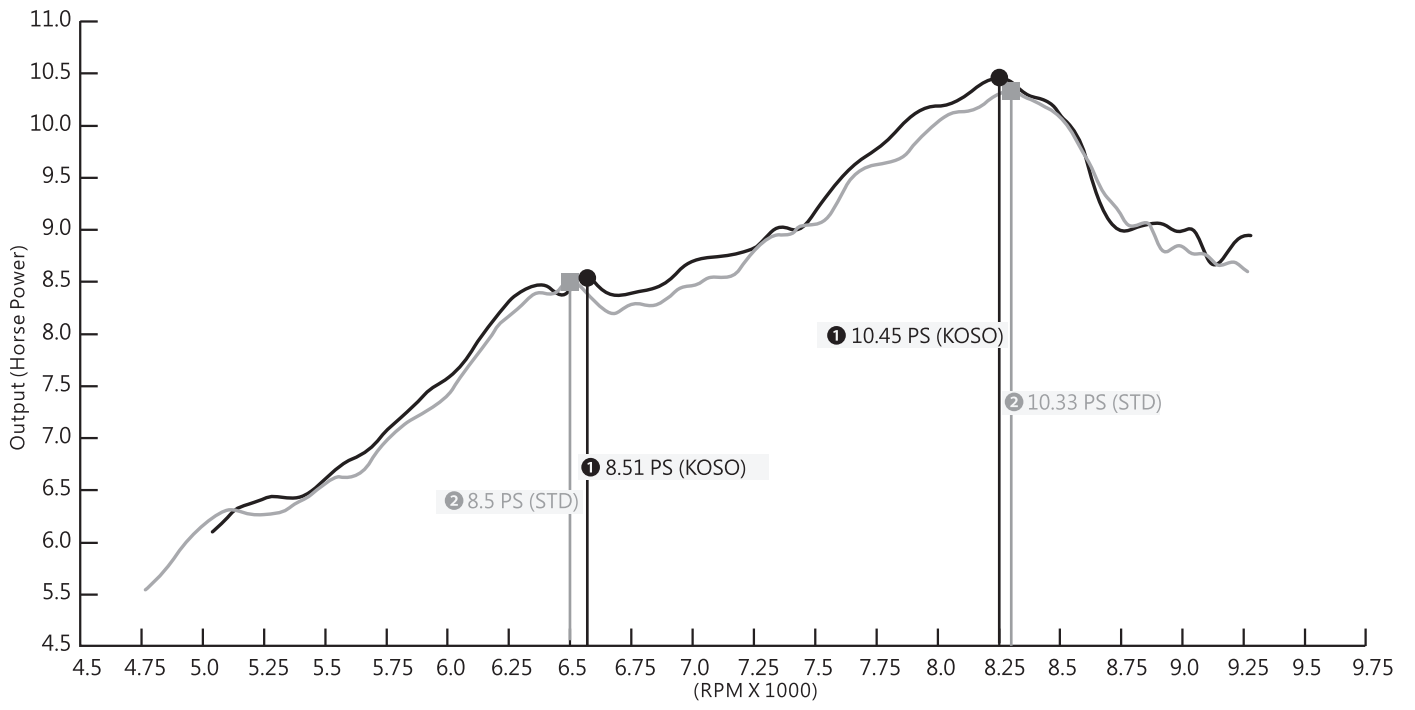

NOTE 1 KOSO YAMAHA CYGNUS GRYPHUS AIR CLEANER COVER.

NOTE 2 YAMAHA CYGNUS GRYPHUS AIR CLEANER COVER.