



● Thank you for purchasing The Product. Before installation, please read the instruction carefully. We recommend that you store the instruction sheet in a safe place for future reference.

## ⚠ NOTICE

- To install, follow the steps as described in the manual. Any damages caused by not following directions voids warranty.
- Correct tools must be used for installation.
- Do not modify any parts unless specifically stated in the instruction manual.
- Interior controller maintenance should be performed by a professional only.

## ⊙ EXPLANATION OF SYMBOLS

**NOTE** Read this information carefully regarding the essential features.

⚠ Some processes must follow to avoid the affection caused by wrong installation.

**⚠ CAUTION!** Some processes must follows to avoid the damage to yourself or public.

🔧 Denotes the tightening torque value.

## 1-1 ACCESSORIES

### 1 Sport Clutch X1



**NOTE** Please contact your local distributor if the items received are not the same as the one listed above.

## 1-2 OPTIONAL ACCESSORIES

### 1 Clutch Outer



### 1 Drive Pulley



### 2 Drive Face



### 3 Toeque Spring

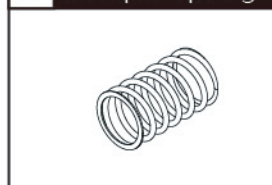

### 4 Roller 20x15mm

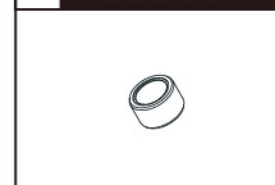

**NOTE** Some of these items may not sell in particular area, for more information, please contact with our local dealer.

## 2-1 INSTALLATION INSTRUCTION

NEW

10  $\times$  55 Nm (550 kgf.cm)

1  $\times$  75 Nm (750 kgf.cm)

: Shell doliun grease R (J)

**NOTE** Some processes must be followed to avoid the affection caused by wrong installation.

## 2-2 SPECIFICATIONS

- Size D123.4 X H 30 mm
- Clutch weight 246g
- Clutch spring free length 31.5mm

### 3 POWER CURVE COMPARE CHART

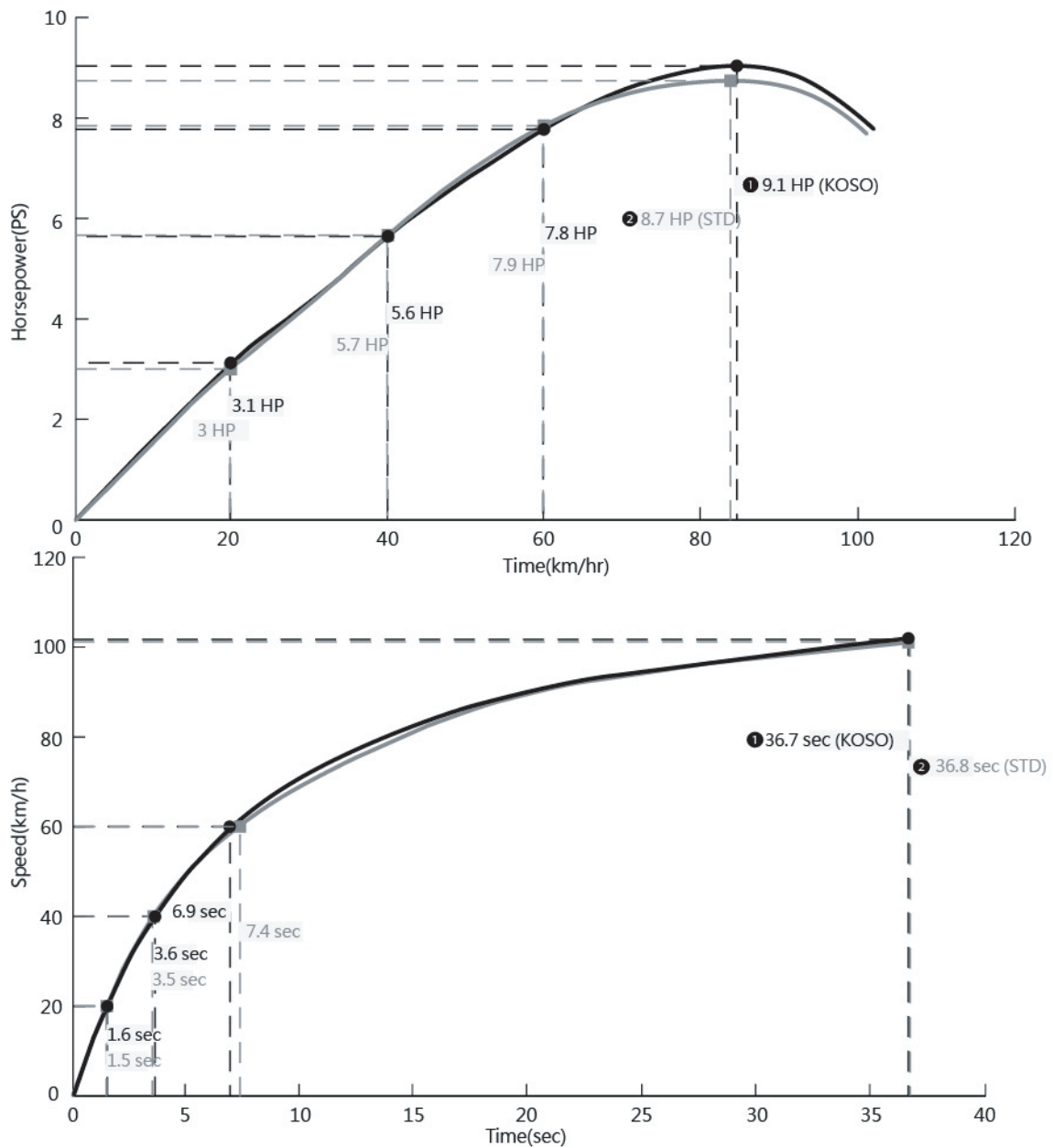

**NOTE 1** KOSO Drive Pulley +KOSO Drive Face+Spring 1000 RPM+Roller (9g x6=54g)+KOSO VESPA Sport Clutch+KOSO VESPA Clutch Outer.

**NOTE 2** KOSO Drive Pulley +KOSO Drive Face+Spring 1000 RPM+Roller (9g x6=54g)+STD VESPA Clutch+STD VESPA Clutch Outer.

**NOTE** Test results vary with testing environment and weather.This test chart is for reference only.