



Thank you for purchasing our product. Please, read the instructions thoroughly and retain them for future reference.

⚠ NOTICE

- To install, follow the steps as described in the manual. Any damages caused by not following directions voids warranty.
- Correct tools must be used for installation.
- Do not modify any parts unless specifically stated in the instruction manual.
- Interior control maintenance should be performed by a professional only.

◉ MARK MEANING:

NOTE You could get the installation details from the information behind the mark.

⚠ Some processes must be followed to avoid the affection caused by wrong installation.

⚠ **WARNING!** Some processes must be followed to avoid damages to yourself or the public.

⚠ **CAUTION!** Some processes must be followed to avoid the damage to the vehicle.

🔧 Denotes the tightening torque value

1 ACCESSORIES

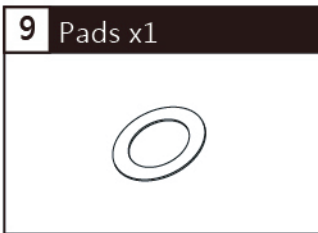
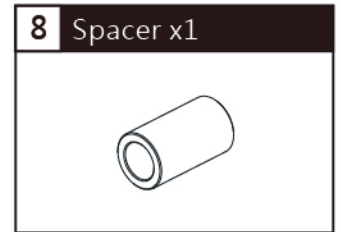
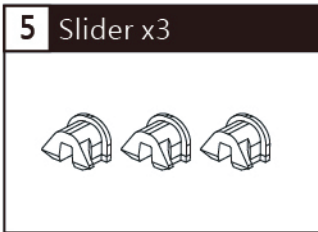
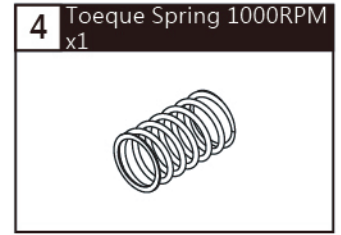
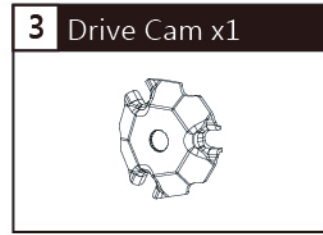
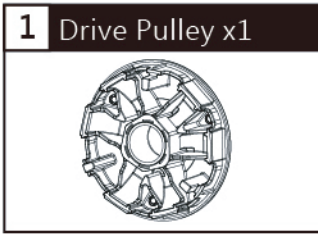

NOTE Please contact the local distributor if the items you open are not the same, as the above-listed one.

2 INSTALLATION INSTRUCTION

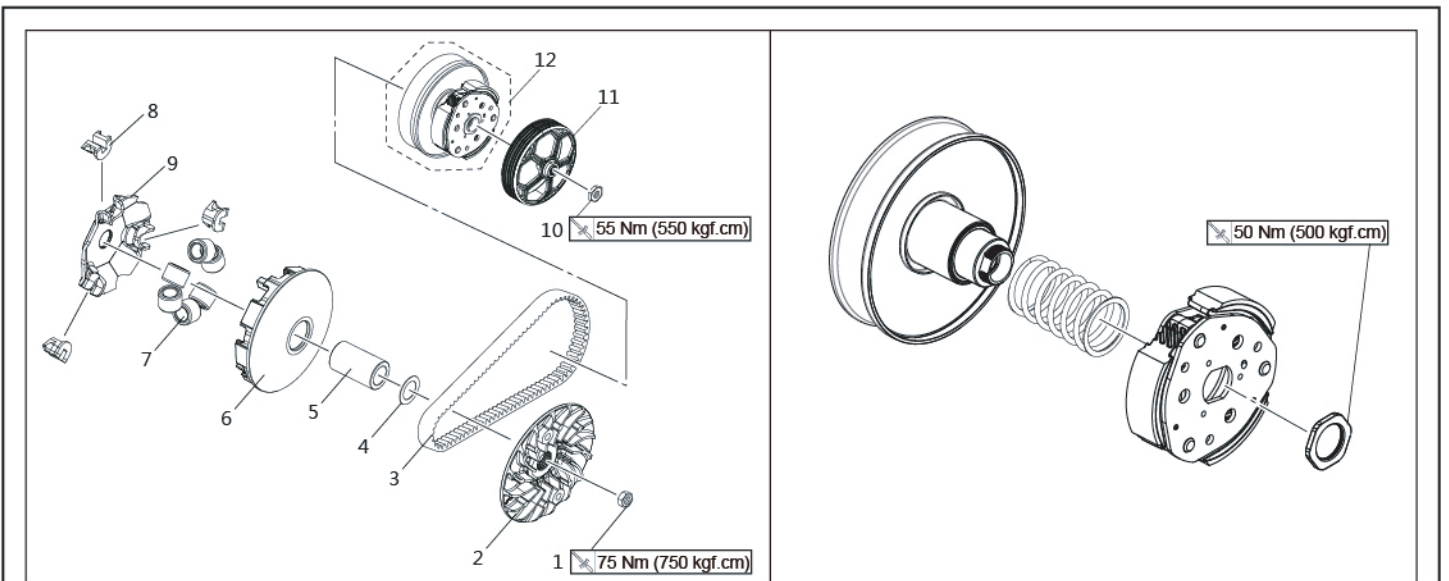

NOTE Please do according to figure in order. Make sure to disassemble the parts in reverse order. Please refer to the above picture for installation sequence.

3 ACCELERATION SPEED TEST DIAGRAM

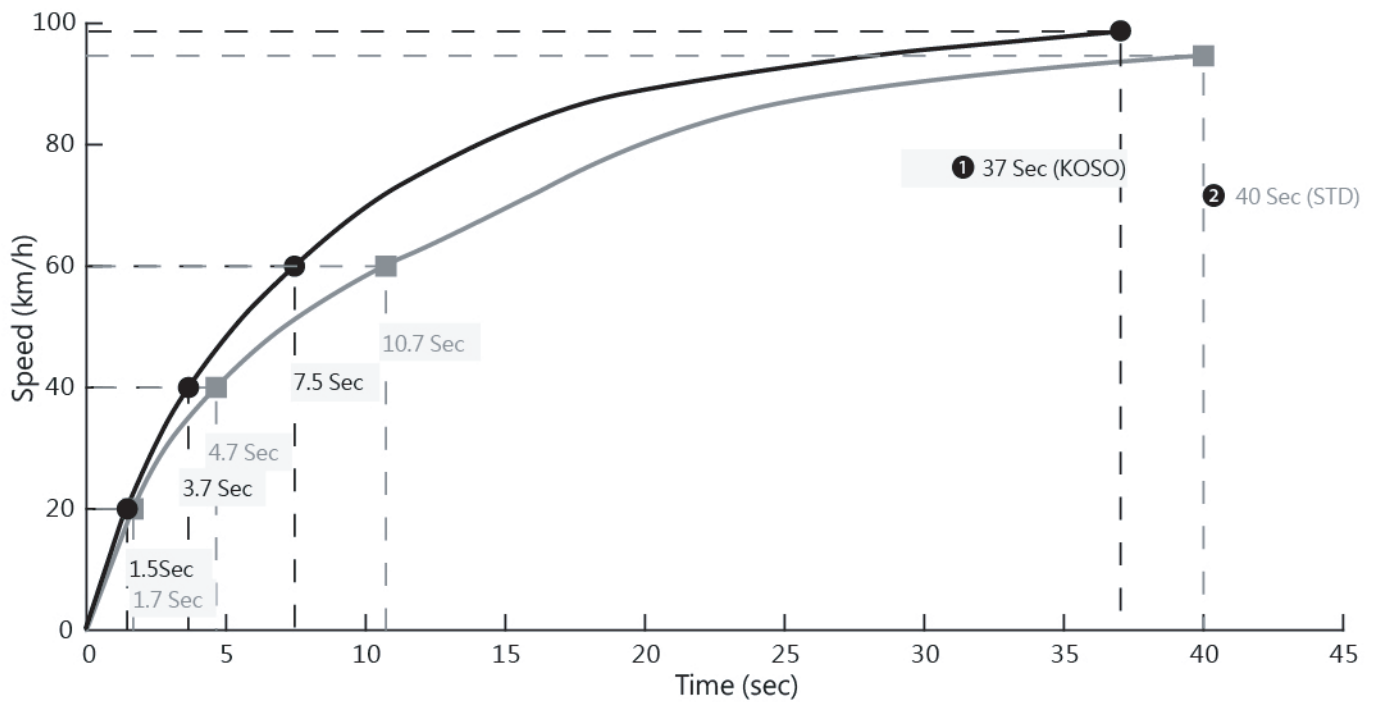
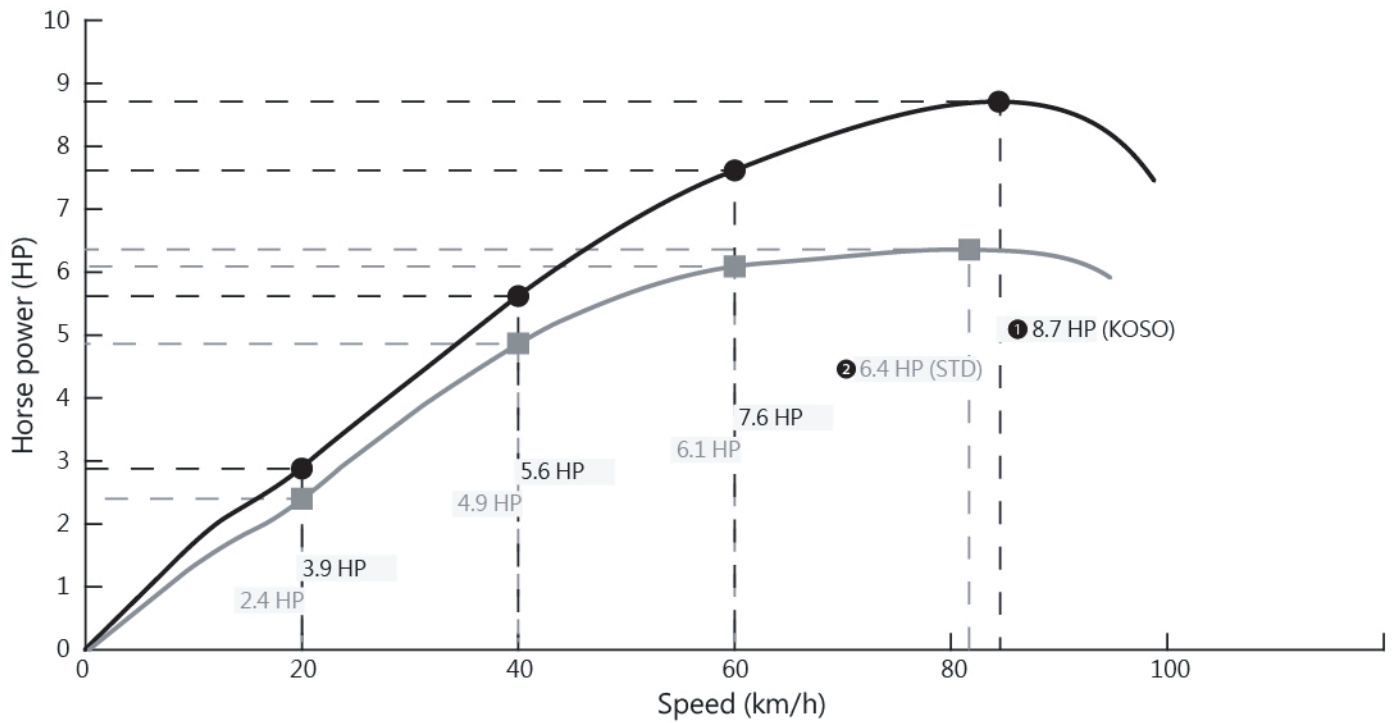

- NOTE 1** Drive Pulley + Drive Face + Drive Cam + Spring 1000 RPM + Slider x3 + Roller (12.5g x3 + 13g x3 = 76.5g) + Spacer + Pads.
- NOTE 2** STD.
- NOTE** Test results vary with testing environment and weather. This test chart is for reference only.